

Track Foundations & Structure.

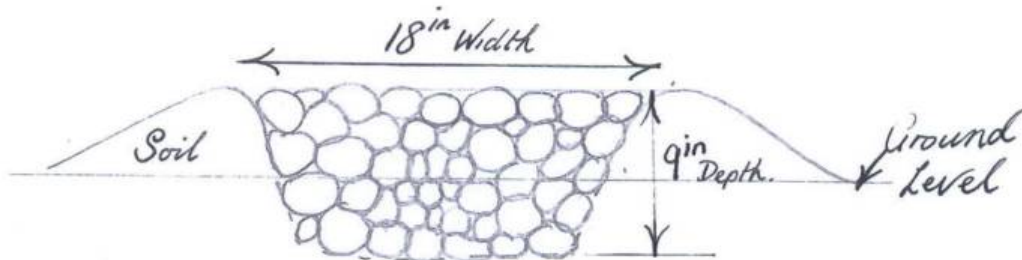

Top Soil will be excavated to 4" deep and compacted on soil on each side of track base, making a ridge raised 5" from ground level. 3" limestone hardcore (clean) will be compacted on a width of 18" along the base of the proposed track. This base will be compatible to the surrounding base rock and soil \therefore easily reinstated back to field.

Track Laying

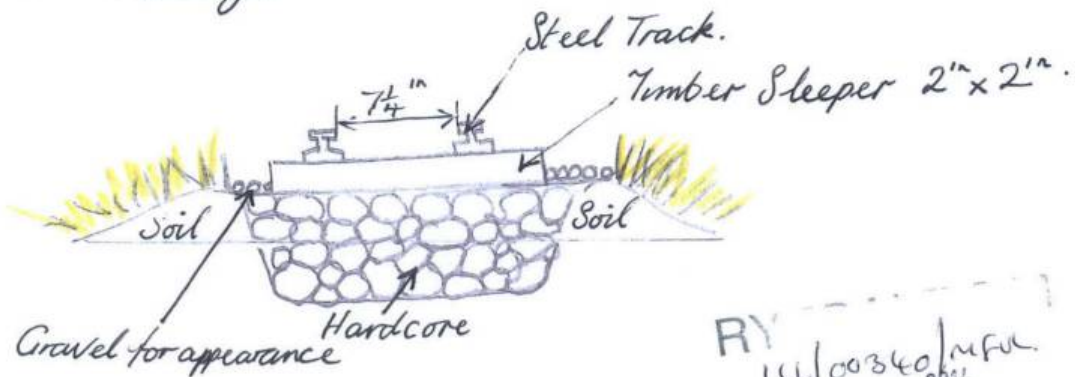

THIS COPY HAS BEEN MADE BY OR WITH THE AUTHORITY OF RYEDALE DISTRICT COUNCIL PURSUANT TO SECTION 57 OF THE COPYRIGHT, DESIGNS AND PATENTS ACT 1988. UNLESS THAT ACT PROVIDES A DELIBERATE EXCEPTION TO COPYRIGHT, THE COPY MUST NOT BE COPIED WITHOUT THE PRIOR PERMISSION OF THE COPYRIGHT OWNER

RY
14/00340/mfu
25 Nov 2014
DEVELOP
MANAGEMENT

Date 10/2/2014 K.A.J. Wick

Pond Layout

WYEDAI
 DEVELOPMENT
 MANAGEMENT
 25 APR 2014

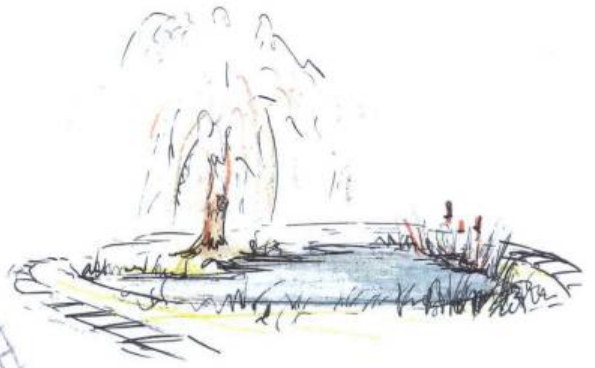
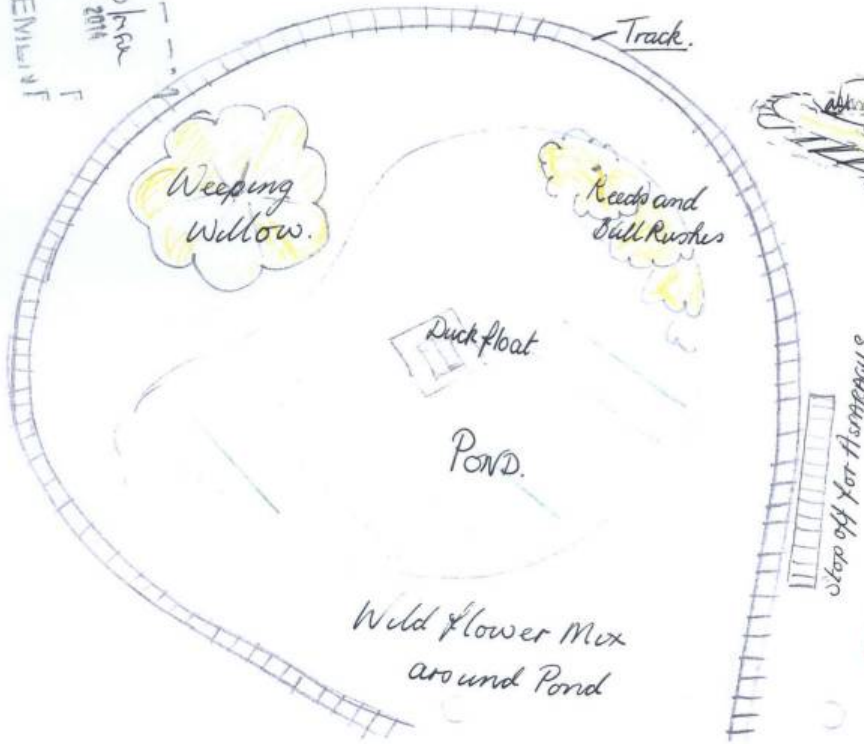

The pond will enhance the landscape and encourage wild life.

Planting with native willow and encouraging reeds & bullrushes to help form habitat for pond life and wild life alike.

THIS COPY HAS BEEN MADE BY US WITH THE AUTHORITY OF WYEDAI DISTRICT COUNCIL. REPRODUCING OR DISTRIBUTING THIS COPY WITHOUT THE WRITTEN PERMISSION OF THE COPYRIGHT OWNER.

Structure of Proposed Tunnel.

MEMORANDUM
for the Director
25 April 2014
DEVELOPMENT
MANAGEMENT

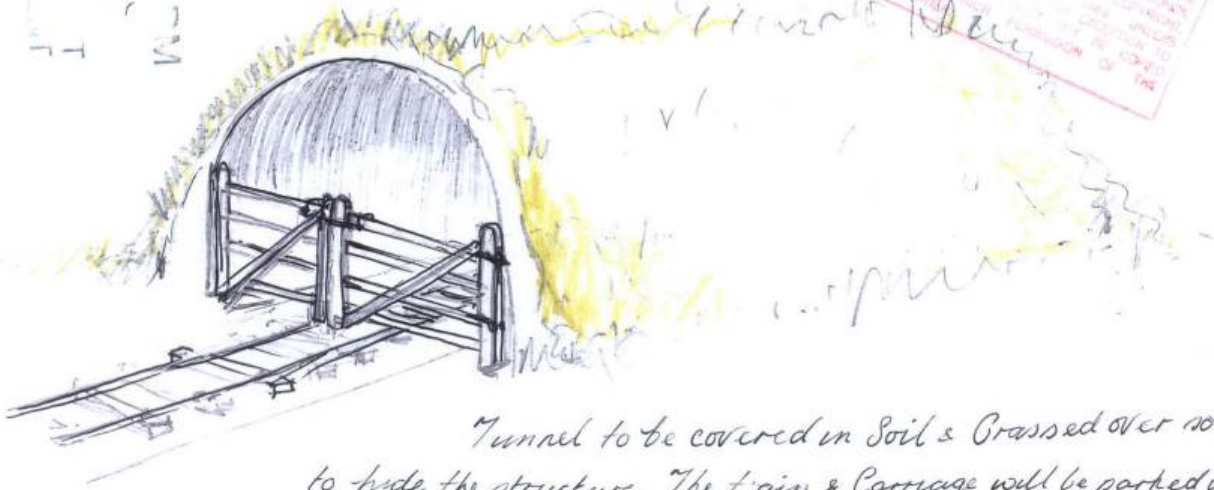

Tunnel to be covered in Soil & Crossed over so as to hide the structure. The train & Carriage will be parked with in the tunnel when not in use with double gates at each end in help security.